

# Good Quality Materials, for YOUR SAFE HOUSE !



**BUILDING MATERIALS** Examine before buying for your home.  
If not, you will be in danger during the next earthquake!

## NOT RECOMMENDED



Avoid using **SMOOTH STEEL** and **USED STEEL** that is rusty, especially for primary reinforcement.

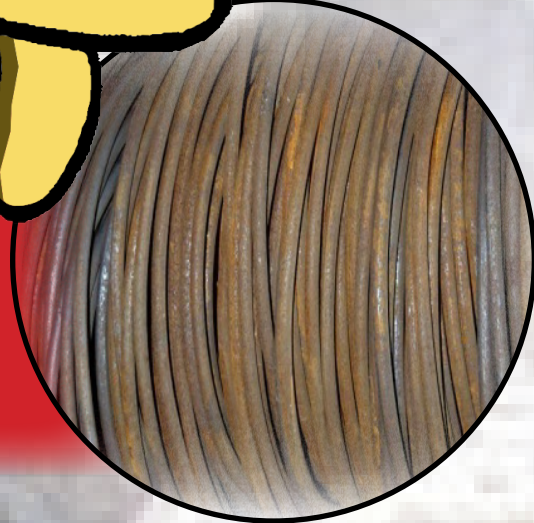

For concrete work, do not use smooth gravel / mixed with soil or sand.



Do not use sand mixed with mud or soil.



Avoid using stones with a smooth or muddy surface for stone masonry work.



Do not use warped wood, wood with fibrous texture, or wood that has a lot of knots and bark.



Do not use weak brick from old buildings and has a lot of cracks.  
*(Test bricks before buying them using the simple method shown. If at least 3 of 7 bricks break when stepped on by an average size man, then the bricks are too weak. Find stronger bricks elsewhere.)*



Test concrete blocks by dropping them from shoulder height. If at least 2 of 5 blocks break, the blocks are not good, and you should search elsewhere for strong blocks.



## RECOMMENDED



For Main Reinforcement, use (SNI) min . Ø 10 mm ( new ribbed steel without rust ).

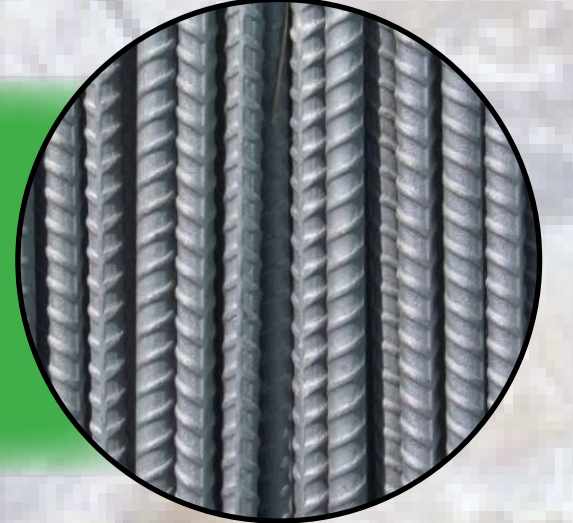

Use gravel / crushed stone. Crushed aggregate will be angular instead of round. The maximum diameter should be 2 cm.



Use clean sand / not dirty and mixed with mud or soil



Use **MOUNTAIN STONE**, sized 15-30 cm, with rough surfaces clean of soil.



Use wood grade I & II with a smooth surface .



Good bricks will not break when subjected to the simplified test. Good bricks are reddish crimson in color and makes a shrill sound when tapped.



Use **STRONG BLOCK**. Strong block will not break when dropped and make a metallic sound when tapped.



### PADANG OFFICE:

JL. BERINGIN IVB NO. 4, LOLONG BELANTI  
PADANG, PROPINSI SUMATRA BARAT  
TLP. 0751-7054538

### TAKENGON OFFICE:

JL. SENGEDA, DESA BUKIT, KEBAYAKAN,  
TAKENGON, KAB. ACEH TENGAH, PROPINSI ACEH  
TLP. 0643-23658



Build Earthquake Resistant Houses  
Change Construction Practice Permanently

[www.buildchange.org](http://www.buildchange.org)  
f Build Change Indonesia  
t @BuildChangeIndo